

第拾四圖

60 FEET SPAN

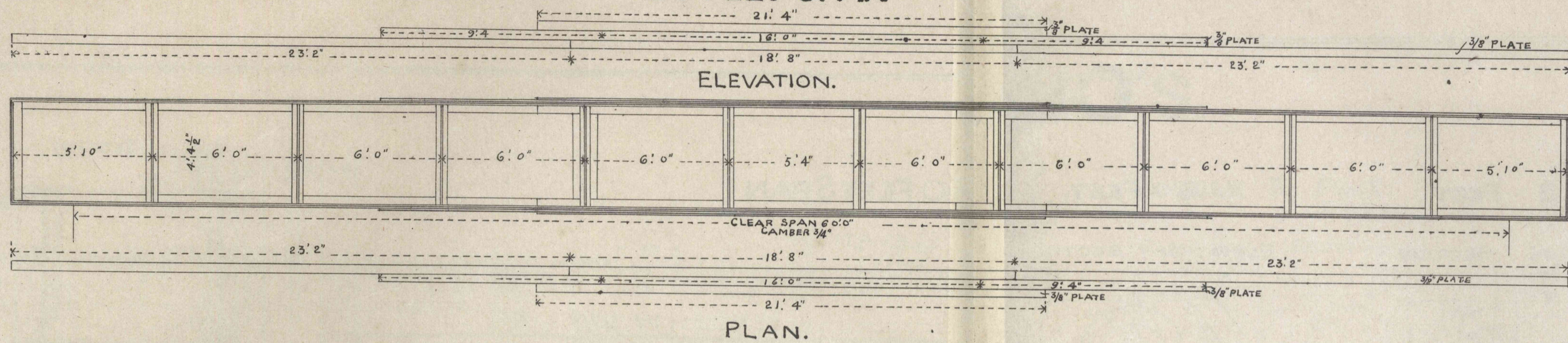

CROSS SECTION

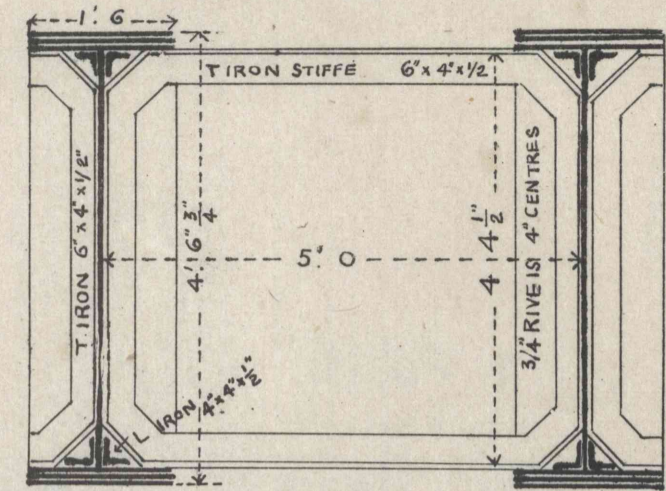

SCHEDULE OF QUANTITIES OF IRONWORK FOR ONE SPAN 60 FEET

NO	DESCRIPTIONS	DIMENSIONS	WEIGHT IN LBS	REMARKS
4	PLATES	18.8 x 1.6 x 3/8	1680	FLANGES
4	DO	21.4 x 1.6 x 3/8	1920	DO
8	DO	9.4 x 1.6 x 3/8	1680	DO
4	DO	16.0 x 1.6 x 3/8	1440	DO
8	DO	23.2 x 1.6 x 3/8	4176	DO
16	DO	6.0 x 4.4 1/2 x 3/8	6300	WEBS
4	DO	5.10 x 4.4 1/2 x 3/8	1531	DO
2	DO	5.4 x 4.4 1/2 x 3/8	700	DO
4	DO	4.6 x 1.6 x 1/2	54	END PLATES
8	DO	3.2 x 1.0 x 3/8	445	WEB COVERS
16	L IRON	23.10 x 4.4 1/2 x 3/8	5084	
8	DO	17.4 x 4.4 1/2 x 3/8	1849	
16	DO	4.0 x 3.5 x 3/8	746	COVERS
2	DO	18.0 x 4.4 1/2 x 3/8	420	INSIDE STIFFENERS
4	DO	5.6 x 4.4 1/2 x 3/8	257	OUTSIDE DO
20	T IRON	5.6 x 6.4 x 3/8	1833	DO DO
10	DO	18.0 x 6.4 x 3/8	3000	INSIDE DO
1250	LINEAL FEET	3/4 RIVET IRON	1845	
			TOTAL	39440

第拾五圖

70 FEET SPAN.

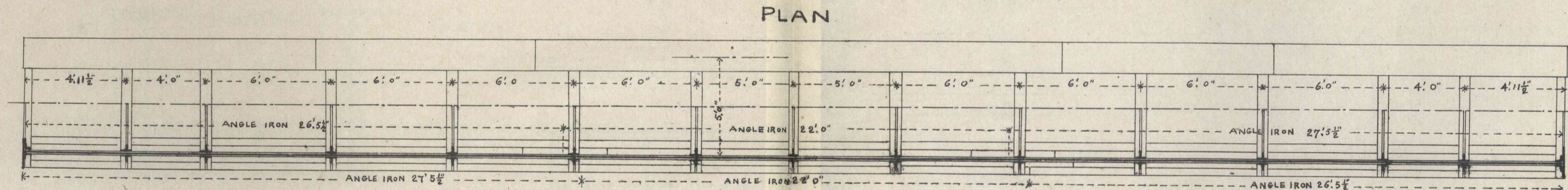
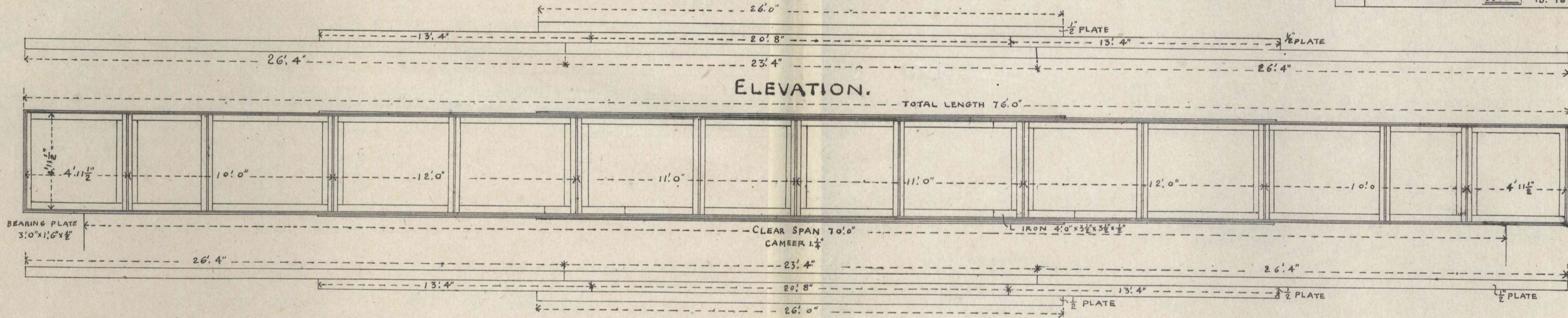

SCHEDULE OF QUANTITIES OF IRONWORK FOR ONE SPAN (70 FEET)

NO	DESCRIPTIONS	SIZE	WT IN LBS	REMARKS
4	PLATES	26.0 x 1.6 x 3/8	3120	FLANGES
4	DO	20.8 x 1.6 x 3/8	2480	DO
8	DO	13.4 x 1.6 x 3/8	3200	DO
4	DO	23.4 x 1.6 x 3/8	2800	DO
8	DO	26.4 x 1.6 x 3/8	6320	DO
4	DO	11.0 x 4.10 x 3/8	3190	WEB
4	DO	12.0 x 4.10 x 3/8	3479	DO
4	DO	10.0 x 4.10 x 3/8	2900	DO
4	DO	4.11 x 4.10 x 3/8	1424	DO
28	DO	4.0 x 1.0 x 3/8	1250	WEB COVERS
16	DO	2.8 x 1.5 x 3/8	320	COVER STRIP
4	DO	4.10 x 1.6 x 3/8	580	END PLATES
8	ANGLE IRON	26.5 1/2 x 4.4 1/2	2816	
8	DO	27.5 1/2 x 4.4 1/2	2920	
8	DO	22.0 x 4.4 1/2	2346	
16	DO	4.2 x 3.5 x 3/8	744	COVERS
2	DO	18.0 x 4.4 1/2 x 3/8	492	BRACING AT END
4	DO	5.6 x 4.4 1/2 x 3/8	306	OUTSIDE STIFFERS
15	T IRON	18.6 x 6.4 x 3/8	4000	INSIDE BRACING
26	DO	6.0 x 6.4 x 3/8	2500	OUTSIDE STIFFERS
820	LINEAL FT	3/4 RIVET IRON	2690	
			TOTAL	49867

CROSS SECTION.

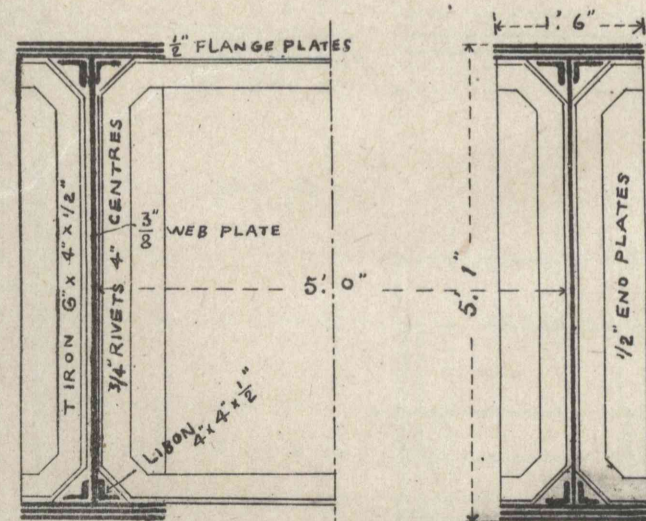

R. whido