

STANDARD STEEL PLATE GIRDERS.

60 FEET SPAN.
ELEVATION.

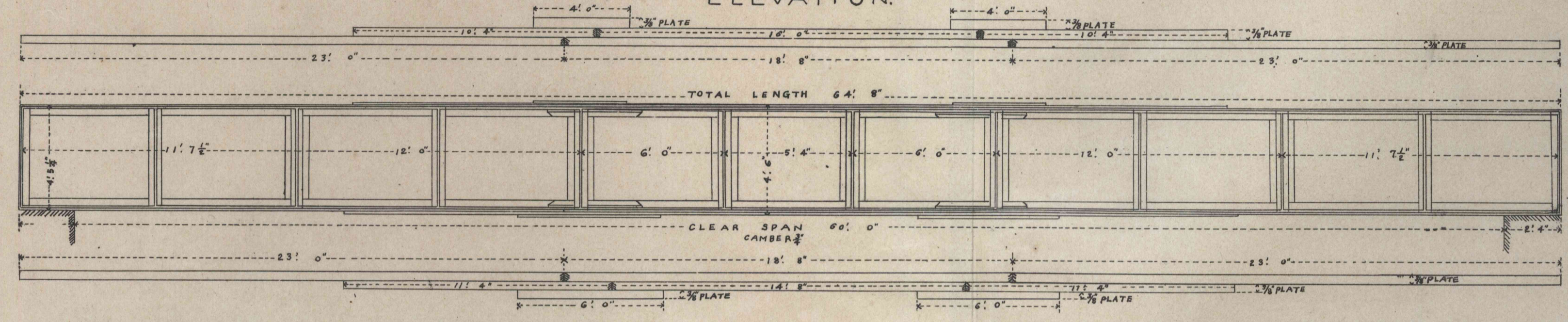

PLAN.

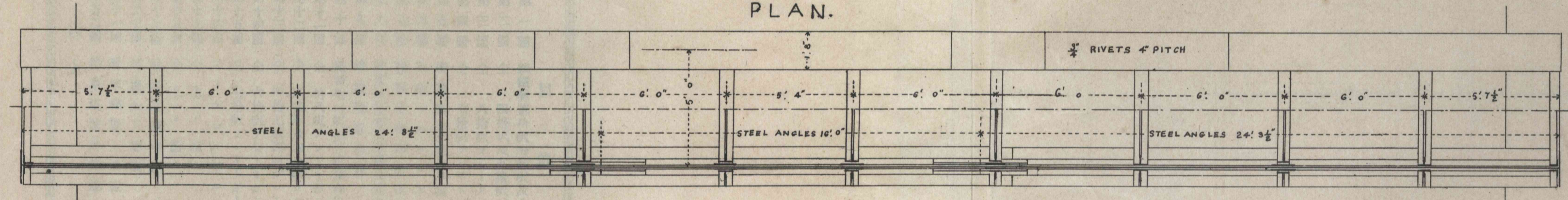

CROSS SECTION

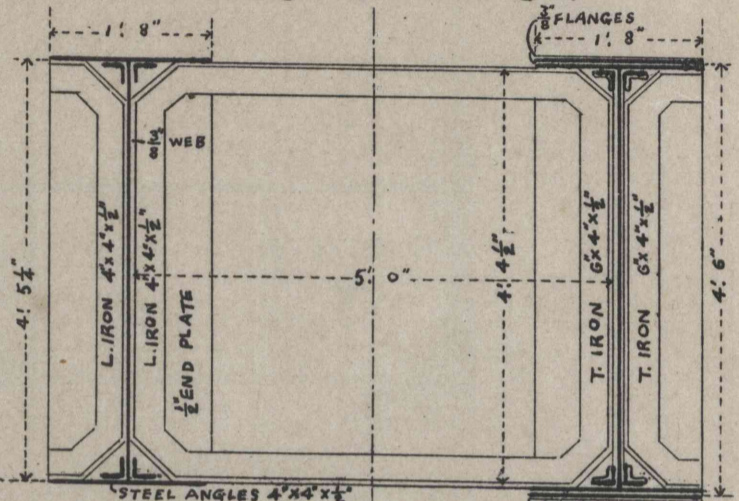

SCHEDULE OF MATERIALS
FOR ONE SPAN.

NO	DESCRIPTIONS	DIMENSIONS	WEIGHT IN LBS	REMARKS
2	STEEL PLATES	14' 0" x 18' 3/8"	829	FLANGES
4	DO	10' 4" x 18' 3/8"	1070	DO
8	DO	23' 0" x 18' 3/8"	4765	DO
4	DO	18' 8" x 18' 3/8"	1934	DO
4	DO	4' 0" x 18' 3/8"	414	FLANGE COVERS
2	DO	14' 8" x 18' 3/8"	759	FLANGES
4	DO	11' 4" x 18' 3/8"	1173	DO
4	DO	6' 0" x 18' 3/8"	624	FLANGE COVERS
4	DO	12' 0" x 4' 4 1/2"	3270	WEBS
4	DO	11' 7 1/2" x 4' 4 1/2"	3173	DO
2	DO	18' 0" x 4' 4 1/2"	1688	DO
2	DO	5' 4" x 4' 4 1/2"	727	DO
24	DO	3' 0" x 11' 0" x 3/8"	1388	WEB COVERS
4	DO	4' 0" x 11' 0" x 3/8"	607	END PLATES
16	STEEL ANGLES	24' 3/8" x 3' 3/8"	5070	CONNECTING WEBS AND FLANGES
8	DO	10' 0" x 3' 3/8"	1664	DO
16	DO	4' 0" x 3' 3/8"	720	ANGLE COVERS
2	ANGLE IRONS	18' 0" x 4' 1/2"	450	STIFFENERS
4	DO	5' 0" x 4' 1/2"	275	DO
10	TEE IRONS	18' 0" x 6' 4 1/2"	2850	DO
20	DO	5' 0" x 6' 4 1/2"	1740	DO
8,250	RIVET HEADS		667	
TOTAL			35,810	= 15' 10" x 5' 11"

NOTE THESE WILL BE DISTINGUISHED FROM SIMILAR IRON SPANS BY THE FLANGES BEING 11' 8" WIDE INSTEAD OF 11' 6".

20 FEET SPAN.
ELEVATION.

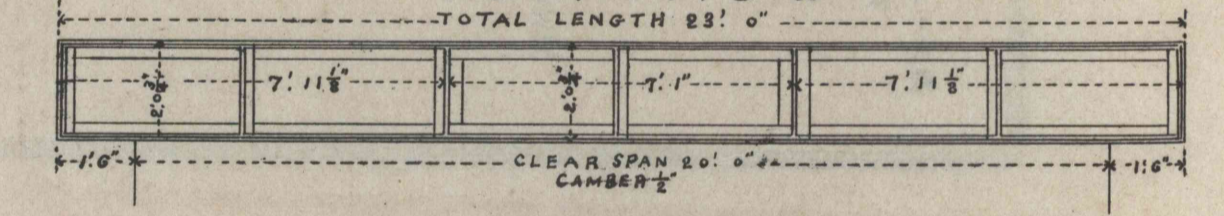

PLAN.

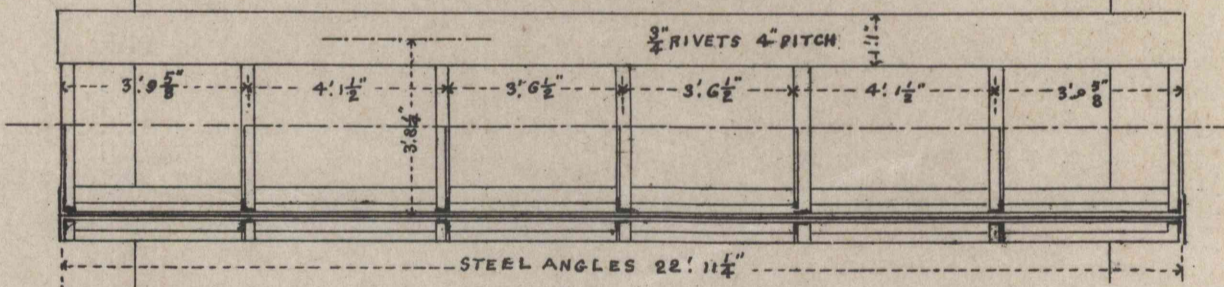

CROSS SECTION

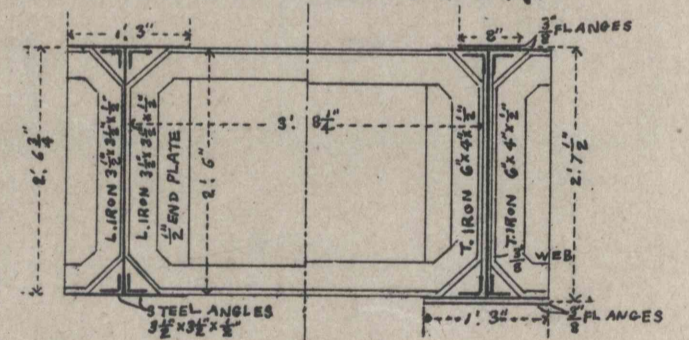

SCHEDULE OF MATERIALS
FOR ONE SPAN

NO	DESCRIPTIONS	DIMENSIONS	WEIGHT IN LBS	REMARKS
2	STEEL PLATES	14' 0" x 18' 3/8"	291	FLANGES
4	DO	33' 0" x 18' 3/8"	3,574	DO
2	DO	14' 0" x 18' 3/8"	340	DO
4	DO	10' 4" x 18' 3/8"	1,686	WEBB
2	DO	11' 4" x 18' 3/8"	884	DO
2	DO	11' 4" x 18' 3/8"	239	WEB COVERS
4	DO	6' 0" x 18' 3/8"	260	END PLATES
8	STEEL ANGLES	22' 11 1/2" x 3' 3/8"	2,966	CONNECTING WEBS AND FLANGES
8	ANGLE IRONS	11' 4" x 3' 3/8"	982	STIFFENERS
16	DO	3' 5' 3/8" x 3' 3/8"	563	DO
2	TEE IRONS	11' 4" x 6' 4 1/2"	359	DO
4	DO	3' 5' 3/8" x 6' 4 1/2"	200	DO
3,584	RIVET HEADS		273	
TOTAL			11,217	= 8' 0" x 11"

NOTE THESE WILL BE DISTINGUISHED FROM SIMILAR IRON SPANS BY THE FLANGES BEING 15" WIDE INSTEAD OF 12".

30 FEET SPAN.
ELEVATION.

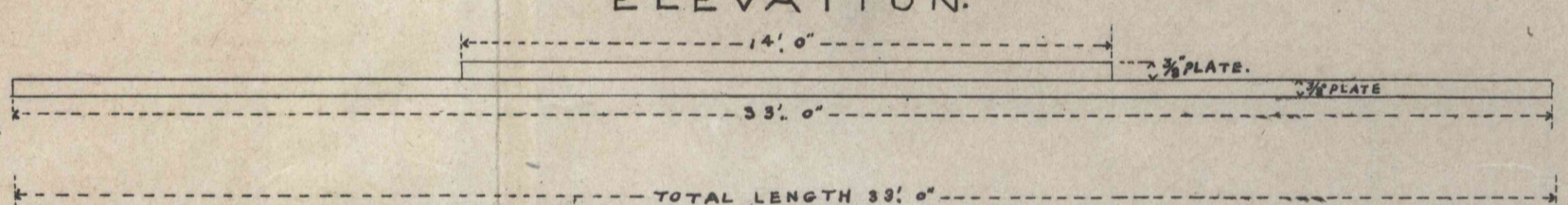

PLAN.

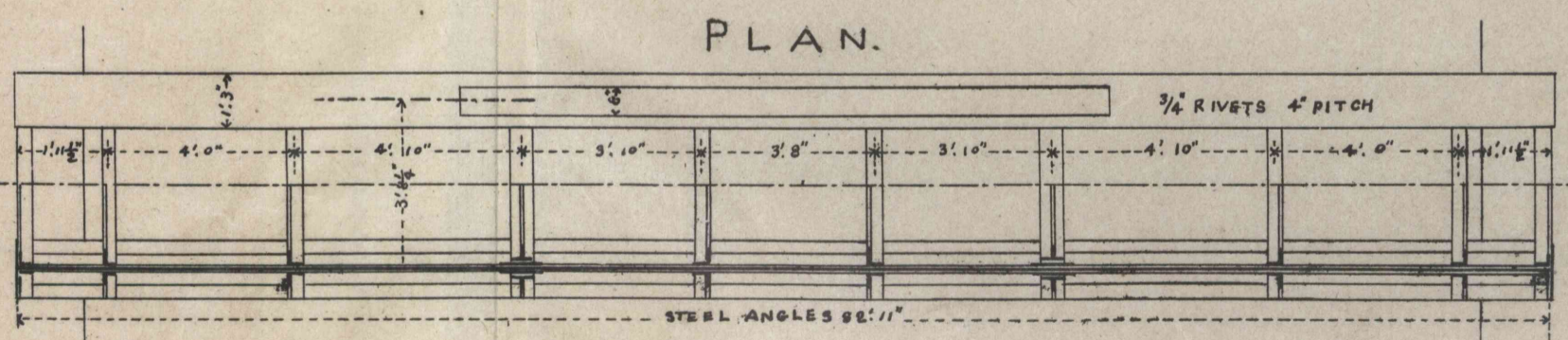

NOTE THESE WILL BE DISTINGUISHED FROM SIMILAR IRON SPANS BY THE FLANGES BEING 15" WIDE INSTEAD OF 14".

R. Uchida